

SPECIFICATION

APPLICATIONS

General lighting for environments where unobtrusive lighting with exceptional even illumination is required.

FEATURES

Side mounted micro perforated lamp shield with white acrylic overlay eliminates lamp image while providing superior even and balanced illumination.

OPTICS

High reflectance (91%) white polyester powder coat providing 65.1% total luminaire efficiency with 1.66 space mounting height ratio.

HOUSING

Premium 20 gauge cold rolled steel housing / micro-perforated metal shield.

ELECTRICAL

Electronic Ballast: Inherent Thermal Protection.
Minimum starting temperature 0°C. UL cUL Listed.

MOUNTING

Suitable for standard exposed grid (T-bar) ceilings.
Equipped with Safety Earthquake Clips.

CERTIFICATION

ETL Listed to UL/cUL standards 1598

OPTIONS

Integral Emergency battery back-up. Slow blow fuse and holder.
Custom color finish (*must supply color chip*). 6 foot Flex Whip Connection. Drywall Flange Kit.

DARLINE[®] by DĀLUME[®]



RECESSED LINEAR

DRL1312
ARCHITECTURAL
1X2 RECESSED Direct/ Indirect Wall Wash
Side Mounted

Fixture Number	# of Lamps	Type of Lamp	Ballast	Options
DRL1312	-1: 1 Lamp	40TT5: 40W TT5* 55TT5: 55W TT5	-120: 120V Electronic -277: 277V Electronic -UE: Universal (120-277V) Electronic -120DIM: 120V Dimming -277DIM: 277V Dimming -UD*: Universal (120-277V) Dimming	-EM: Emergency Pack -SBF: Slow Blow Fuse -CC: Custom Color -FL: Drywall Flange Kit -FW: 6' Flex Whip

*Universal Dimming Available

Example:

DRL1312 -2 40TT5 UE EM



DALUME / Division of EEMA Industries
www.dalume.com

Project Information:

Type:
Project Name:
Cat No.:
Lamp(s):
Volts/Ballast:

5461 West Jefferson Boulevard, Los Angeles, CA. 90016
Tel: 323.904.0200 Fax: 323.904.0201

Specifications subject to change without notice.

A5.1

DIMENSIONS

A: Housing Depth:	3 7/8"	(98.425 mm)
B: Housing Length:	11 3/4"	(298.45 mm)
C: Housing Width:	23 5/8"	(600.075 mm)
D: Diffuser Width:	10 5/8"	(269.9 mm)
E: Flange:	1/4"	(6.35 mm)

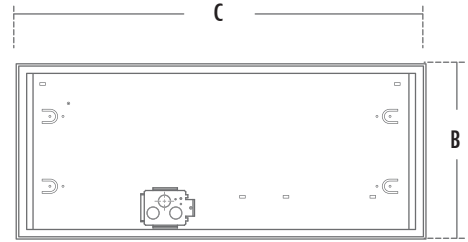
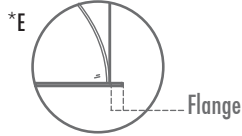
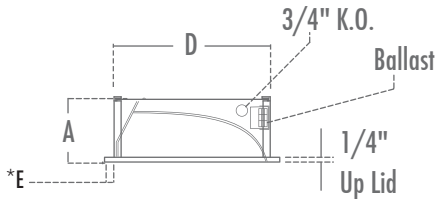

PHOTOMETRIC DATA

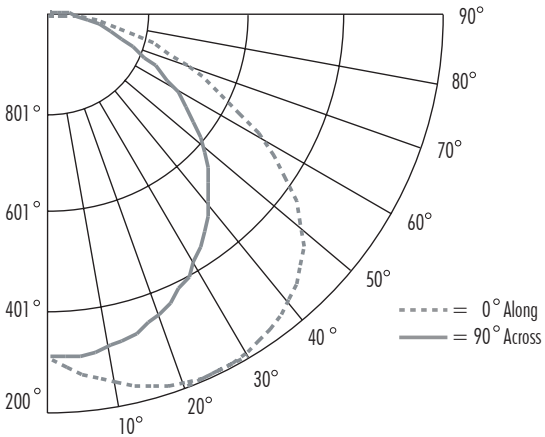

ZONAL LUMEN SUMMARY

ZONE	LUMENS	%LAMP	%FIXT.
0-30	552.84	17.6	26.9
0-40	910.81	28.9	44.4
0-60	1623.88	51.6	79.1
0-90	2051.72	65.1	100
90-120	0	0	0
90-130	0	0	0
90-150	0	0	0
90-180	0	0	0
0-180	2051.72	65.1	100

Total Luminaire Efficiency = 65.1%

CANDELA

	0°	45°	90°
0	701	701	701
5	732	728	701
10	761	745	692
15	783	753	676
20	798	756	653
25	801	750	624
30	796	736	589
35	780	712	548
40	755	679	501
45	718	637	450
50	664	587	395
55	584	524	335
60	487	447	274
65	370	354	213
70	293	253	156
75	211	171	104
80	129	100	57
85	56	37	23
90	0	0	0

RECESSED Linear Direct/ Indirect 1X2

(1) 40W T5 Compact Fluorescent Lamp

Total Rated Lamp mean Lumens 3150

Spacing Criteria (0-180) 1.66

IESNA:LM-63-2002

Test Number 1312PH

DRL1312-140TT5UE

Total Luminaire Efficiency 65.1 %

COEFFICIENTS OF UTILIZATION

RC	80%				70%				50%			30%			10%			0%
	70	50	30	10	70	50	30	10	50	30	10	50	30	10	50	30	10	0
0	78	78	78	78	76	76	76	76	72	72	72	69	69	69	66	66	66	65
1	71	68	65	62	69	66	64	61	63	61	59	61	59	58	59	57	56	55
2	64	59	54	51	63	58	54	50	55	52	49	53	50	48	51	49	47	45
3	59	52	46	42	57	51	46	42	49	44	41	47	43	40	45	42	40	38
4	54	46	40	36	52	45	40	35	43	39	35	42	38	34	40	37	34	32
5	49	41	35	31	48	40	35	30	39	34	30	37	33	30	36	32	29	28
6	45	37	31	27	44	36	31	27	35	30	26	34	29	26	33	29	26	24
7	42	33	28	24	41	33	27	23	32	27	23	31	26	23	30	26	23	22
8	39	30	25	21	38	30	25	21	29	24	21	28	24	21	27	23	20	19
9	37	28	22	19	36	27	22	19	27	22	19	26	22	19	25	21	18	17
10	34	26	20	17	33	25	20	17	25	20	17	24	20	17	23	20	17	16

DALUME[®]
Decorative & Architectural Lumination

Project Information:

Type: